

1. HUI / LUI CYC to GROUNDROW CONVERSION

To change a cyc to a groundrow simply reverse the colour cassette by removing the two pivot hinge screws (one on either side).

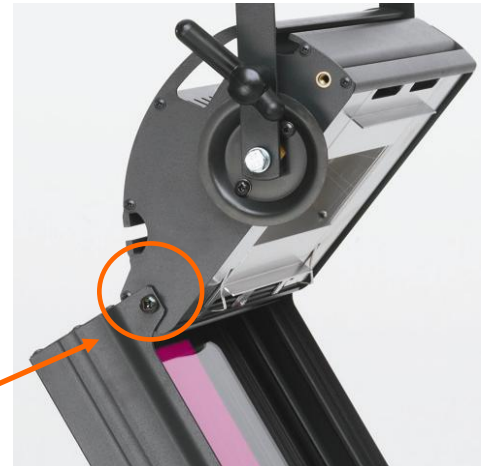
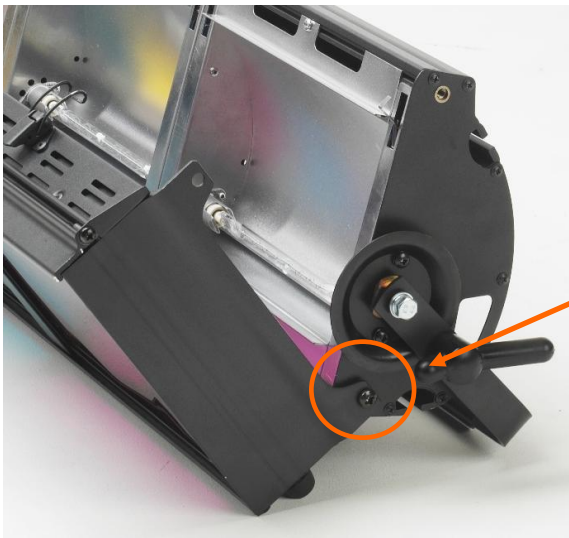

Angle adjustments can be made by using the yoke and/or the screw-in feet which are available as an

accessory.



2. MAKING UP YOUR OWN BATTENS

Using the Hui / Lui Slot Lock system allows you to join any number of units together.

